

## Installation Phases - Entire Room

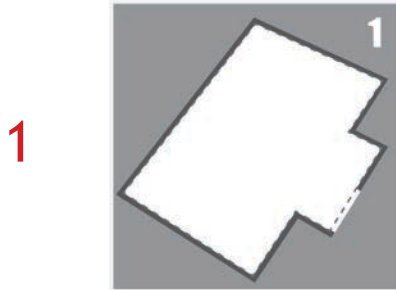

1. Select the installation area.

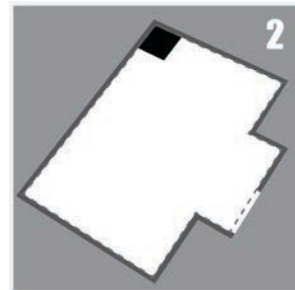

2. Lay the first tile in the angle.



3. Continue laying the first row till it's possible.

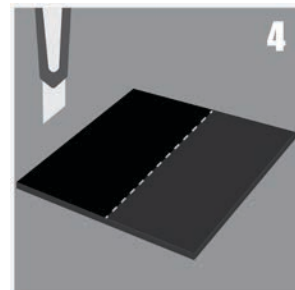

4. Split a tile in two halves.

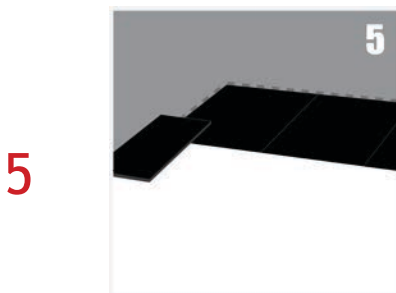

5. Start the second row using a half tile.

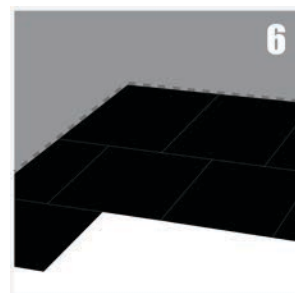

6. Continue the installation, starting the rows alternately with an entire or an half tile.

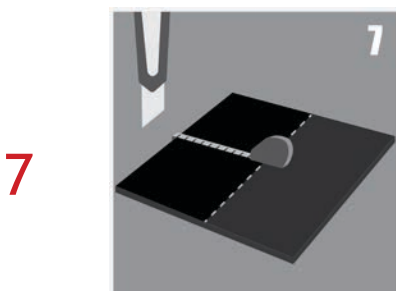

7. Measure the empty spaces and cut the tiles to fill the gaps.

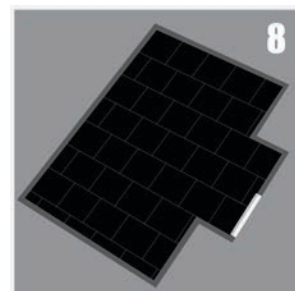

8. Complete the installation and place a profile at the gateway.